

LOC		DIST		REVISIONS			
GP	0	P	LTR	DESCRIPTION	DATE	DWN	APVD
		A		RELEASED PER 0512-0632-04	21FEB05	MY	SB

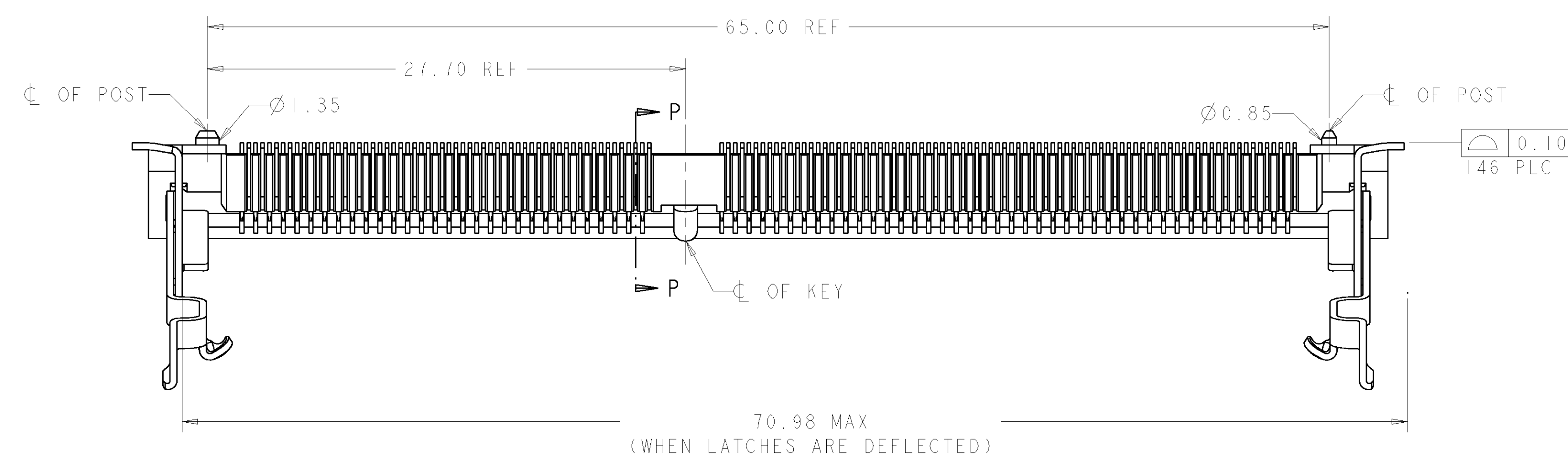

- 1 MATERIAL: HOUSING: HIGH TEMPERATURE PLASTIC - NATURAL
 LATCHES: STAINLESS STEEL UNS S30100
 CONTACTS: PHOSPHOROUS BRONZE
 SOLDER LEADS: PHOSPHOROUS BRONZE
- 2 FINISH: SOLDER LEADS: GOLD 0.00025 MIN IN CONTACT AREA
 MATTE TIN 0.0025 MIN ON SOLDER TAILS
 ALL OVER 0.00130 MIN. THICK NICKEL
 LATCHES: MATTE TIN 0.0025 MIN OVER
 NICKEL 0.00130 MIN.
- 3 MODULE BOARD PAD FINISH: FOR OPTIMUM PERFORMANCE
 SMOOTH AND FLAT
 0.00075 MIN THICK GOLD OVER
 0.00200 MIN THICK NICKEL.

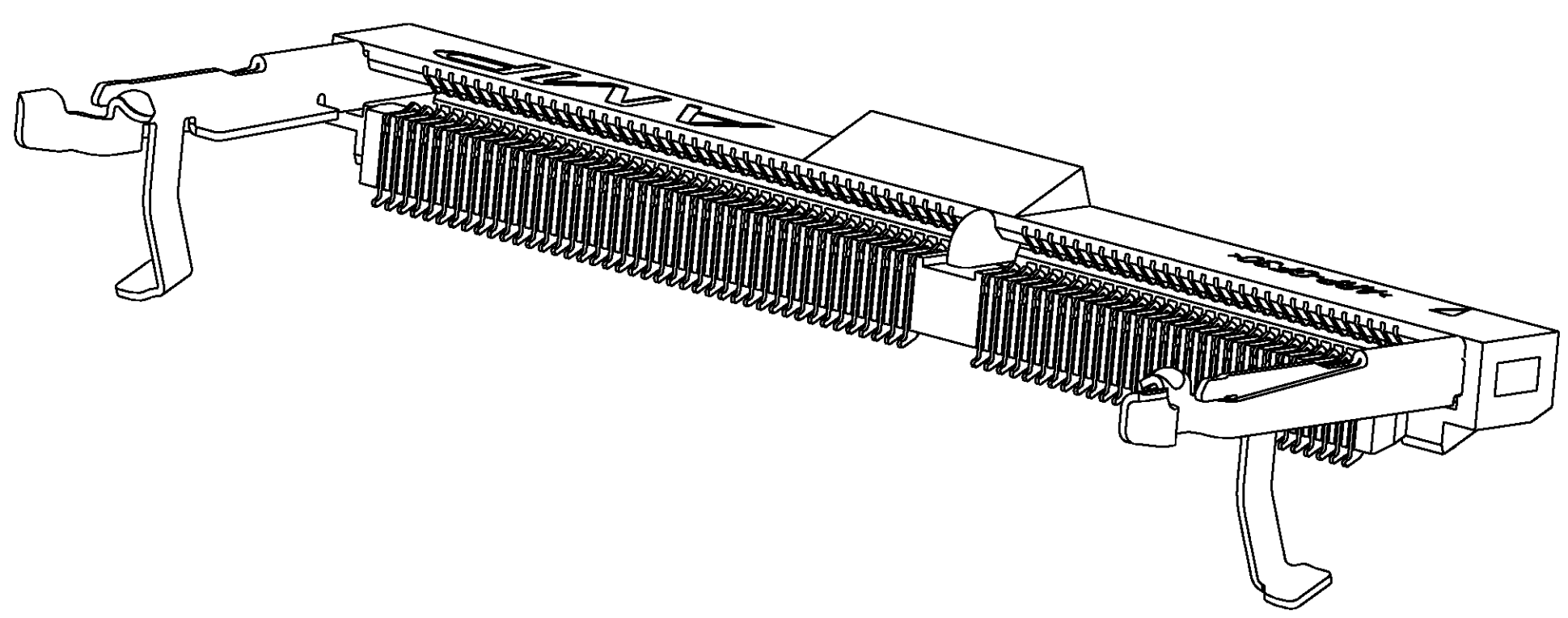
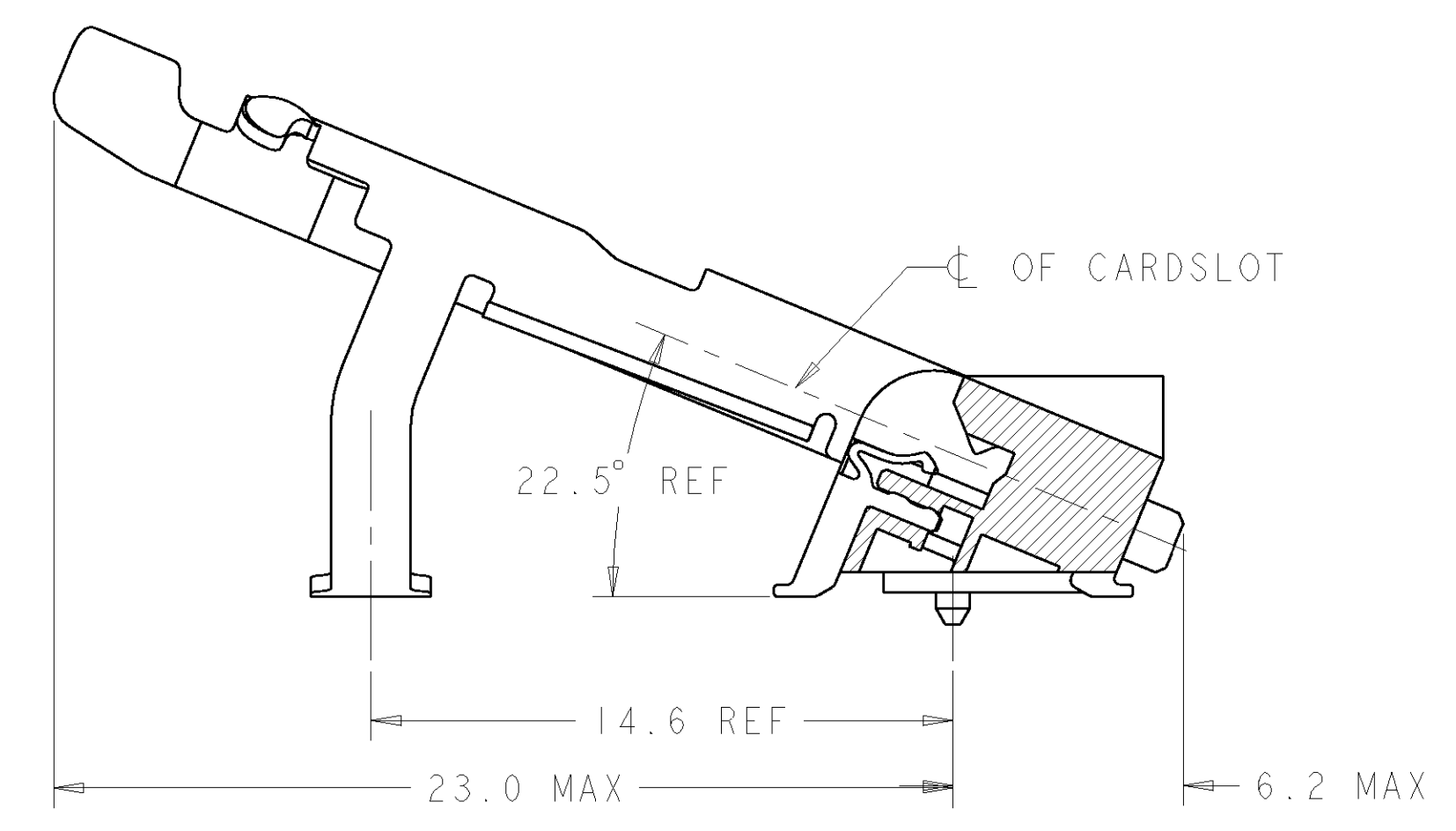
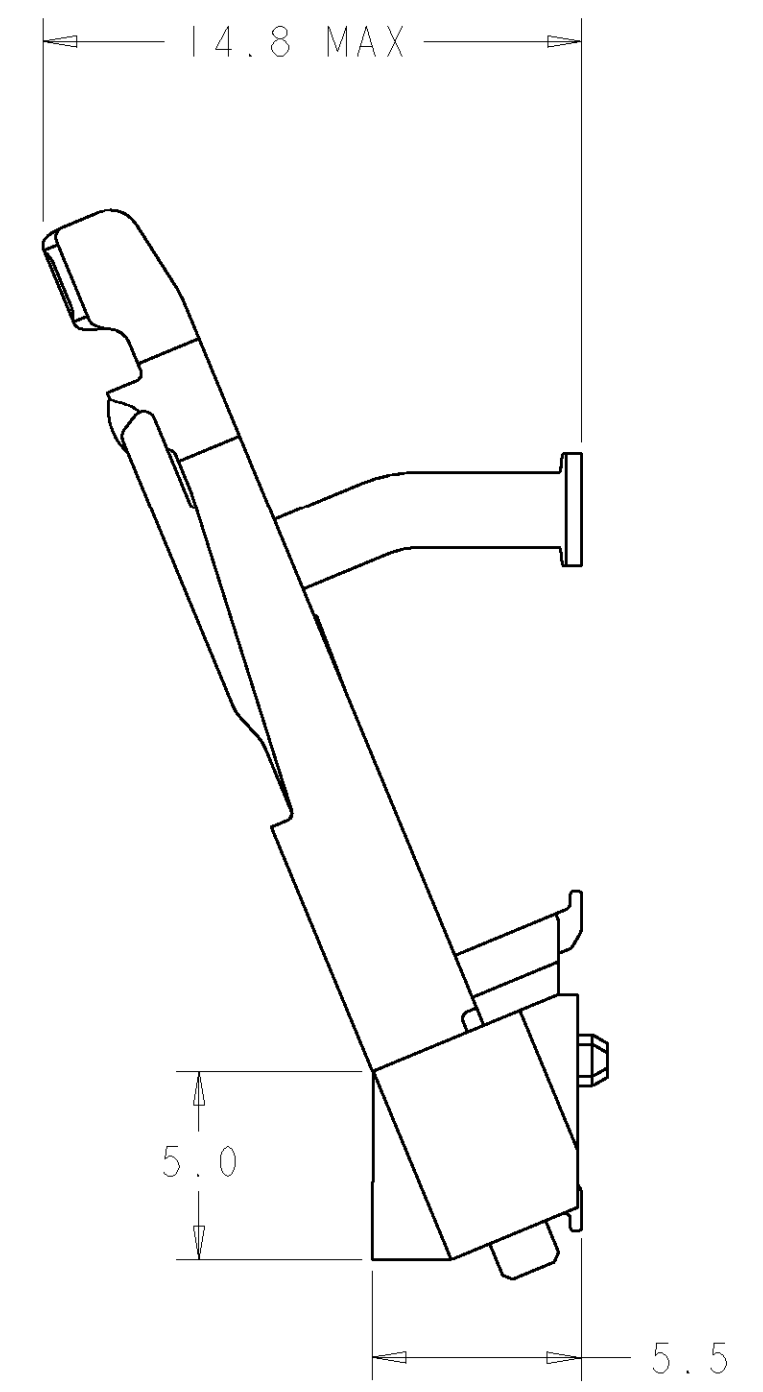
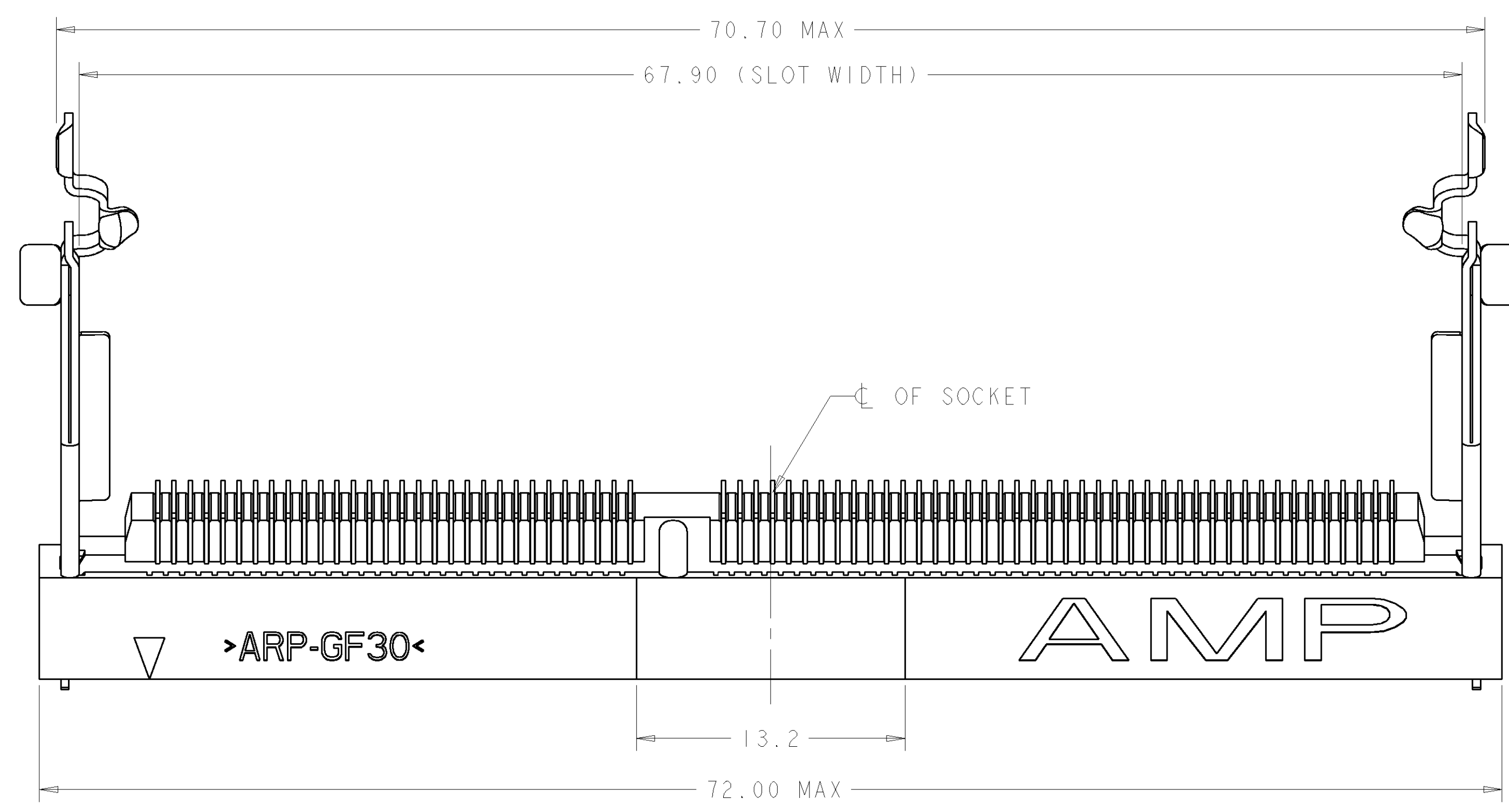

SECTION P-P
 SCALE 6:1

DRAM 3.3V		144	6368063-1
POWER SUPPLY		POSN	PART NUMBER
DWN M. YEOMANS 21FEB05		AMP Incorporated	
ENR M. YEOMANS 21FEB05		Harrisburg, PA 17105-3608	
APVD S. BURKHOLDER 21FEB05		NAME ANGLED S.O. DIMM SOCKET ASSEMBLY	
PRODUCT SPEC -		0.8mm PITCH, 144 POSN, 22.5 DEGREES	
APPLICATION SPEC -		TILT FOR DRAM TYPE MODULE	
MATERIAL 1		SIZE CAGE CODE DRAWING NO RESTRICTED TO	
FINISH 2		A 100779 C-6368063	
CUSTOMER DRAWING		SCALE 5:1 SHEET 1 OF 3 REV A	

REVISONS		DATE	DWN	APVD
GP	0			
DESCRIPTION				
SEE SHEET 1				

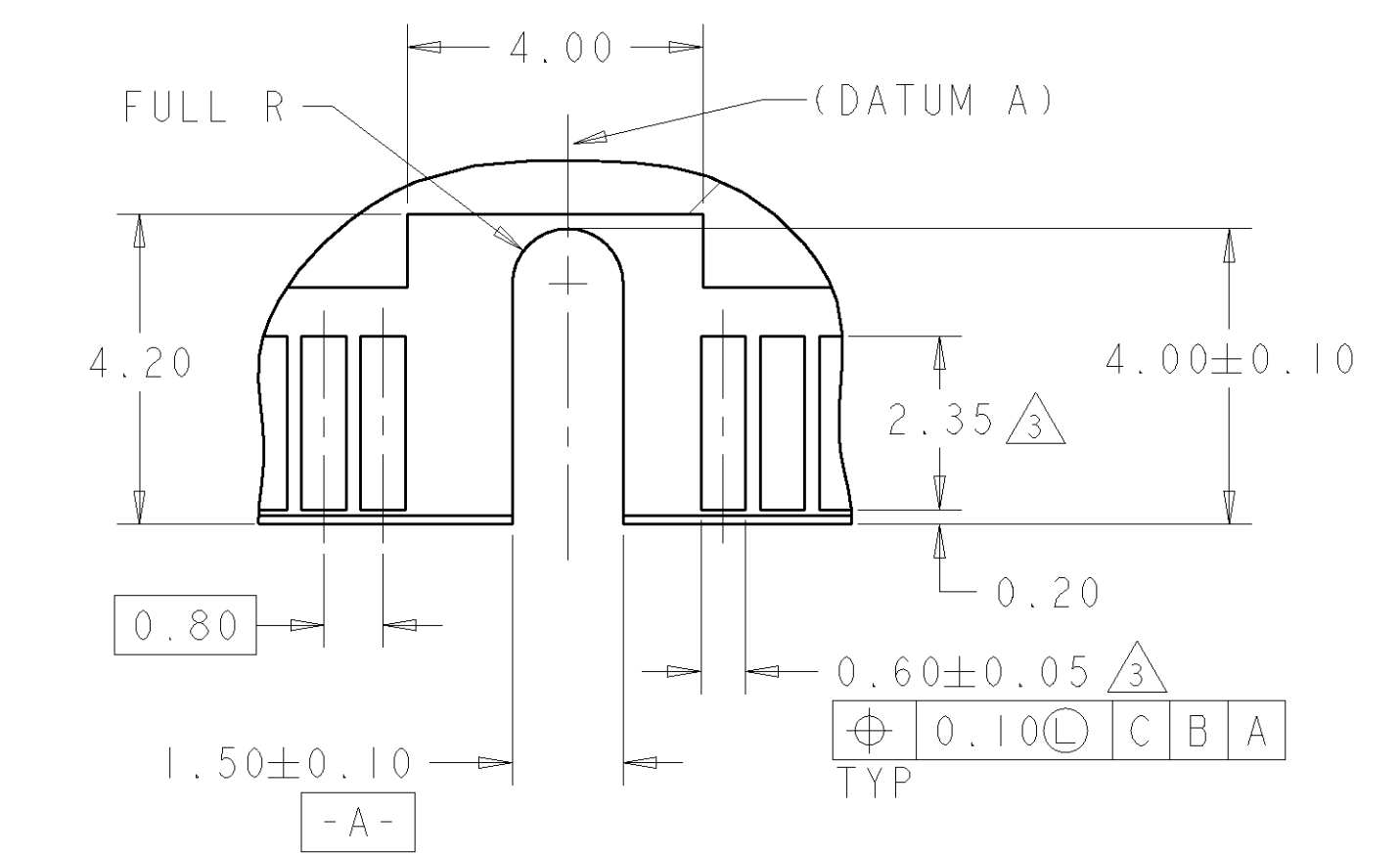
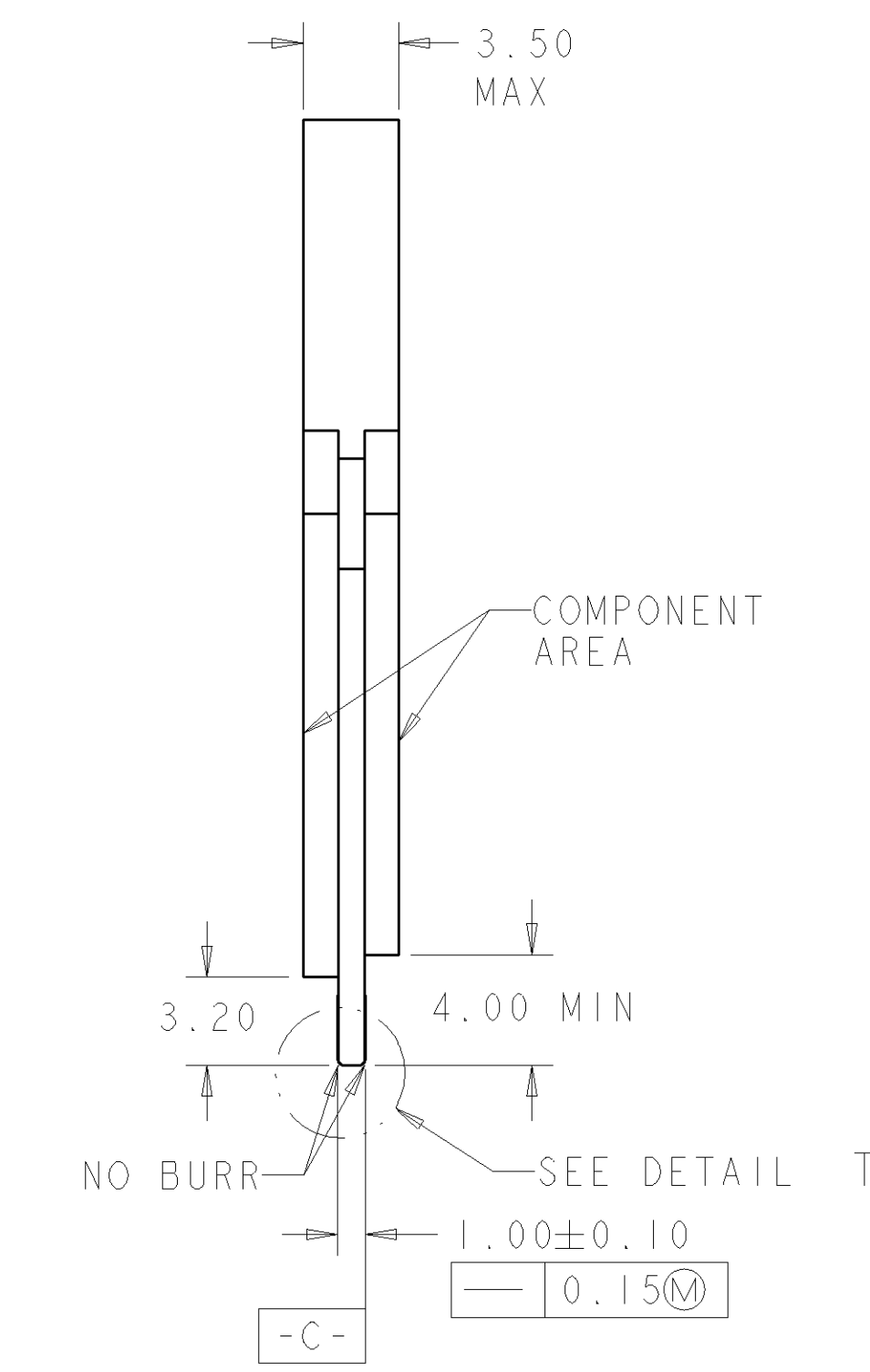
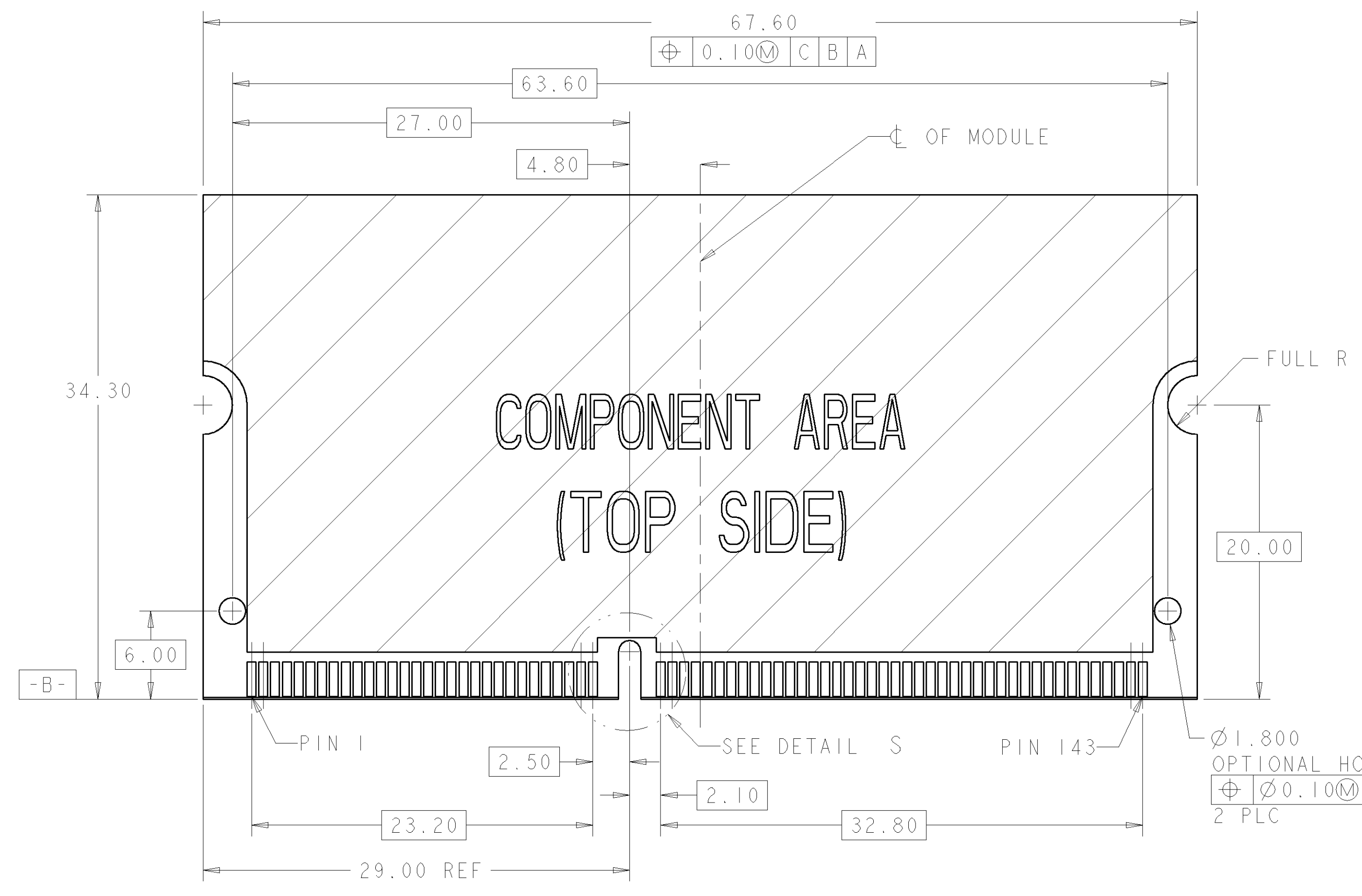

SO DIMM MODULE
SCALE 4:1
(REFER TO JEDEC ITEM MO-190
FOR COMPLETE MODULE SPECIFICATIONS)

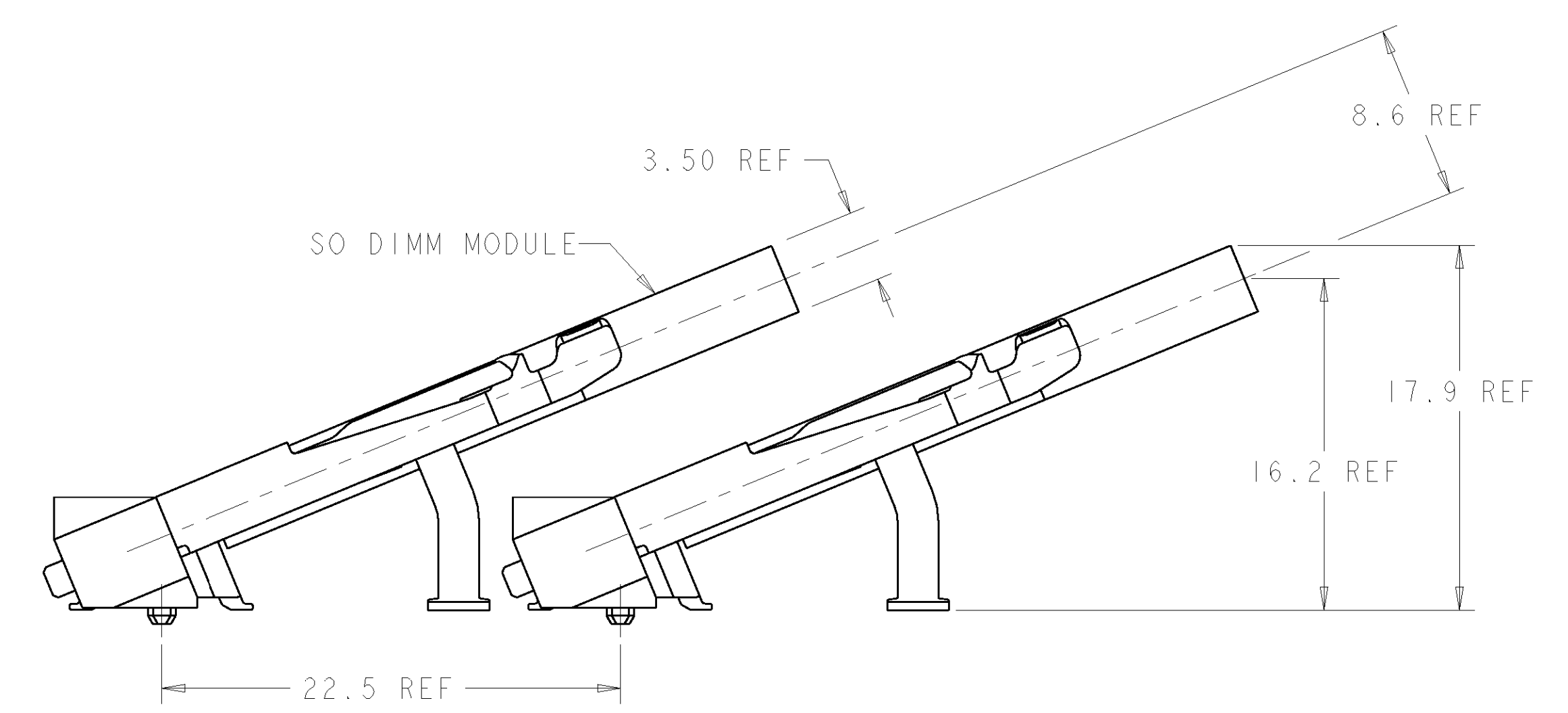
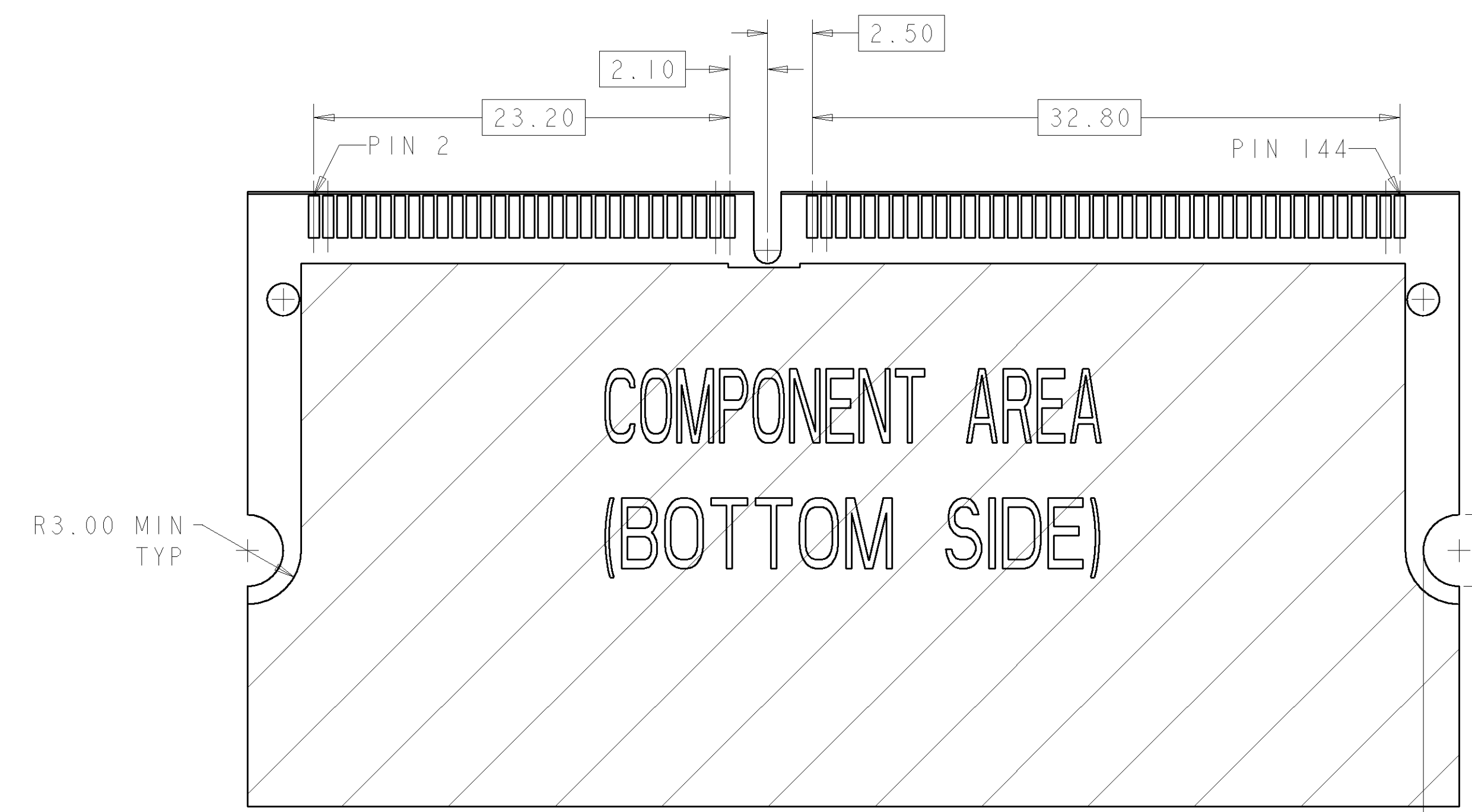
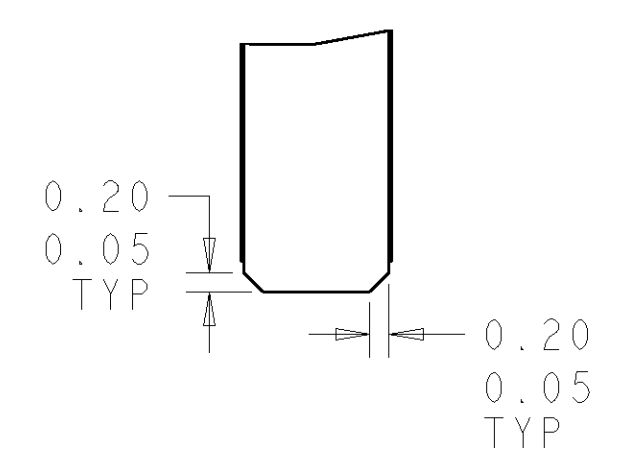
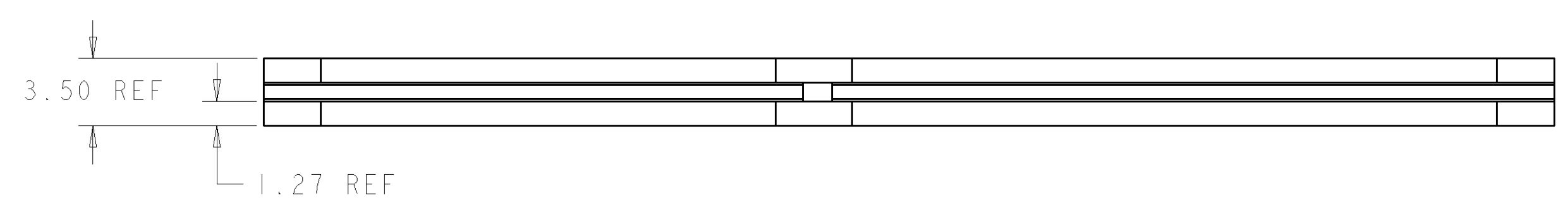

2.00 MIN
2 PLC

DIMENSIONS: mm 		TOLERANCES UNLESS OTHERWISE SPECIFIED: 0 PLC ± 1 PLC ±0.3 2 PLC ±0.20 3 PLC ± 4 PLC ± ANGLES ±1°		DWN M. YEOMANS 21FEB05 ENR M. YEOMANS 21FEB05 APVD S. BURKHOLDER 21FEB05		tyco AMP Incorporated Harrisburg, PA 17105-3608 Electronics	
MATERIAL 		FINISH 		PRODUCT SPEC APPLICATION SPEC WEIGHT CUSTOMER DRAWING		NAME ANGLD S.O. DIMM SOCKET ASSEMBLY 0.8mm PITCH, 144 POSN, 22.5 DEGREES TILT FOR DRAM TYPE MODULE SIZE CAGE CODE DRAWING NO. RESTRICTED TO A100779C-6368063	
SCALE 4:1				SHEET 2 OF 3		REV A	

