

DIMENSIONS

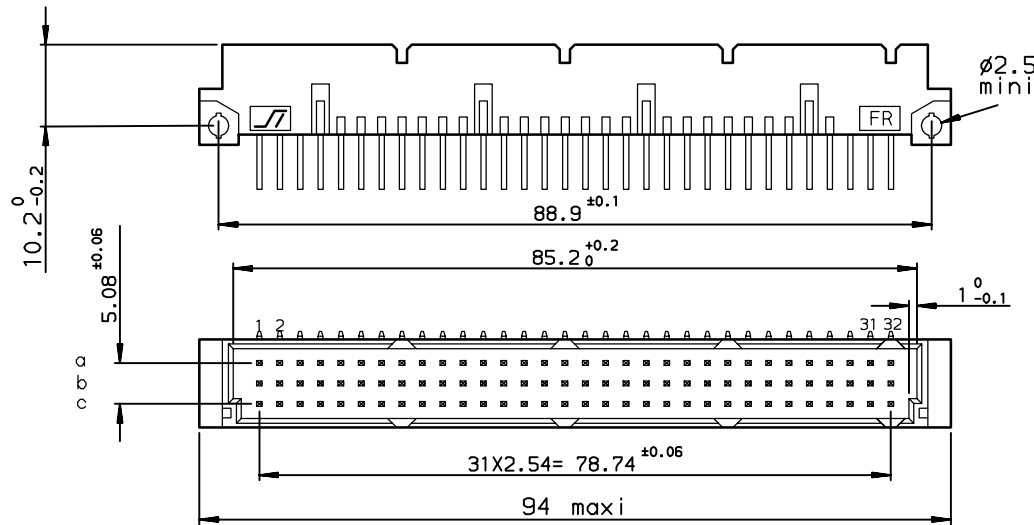

TERMINATION

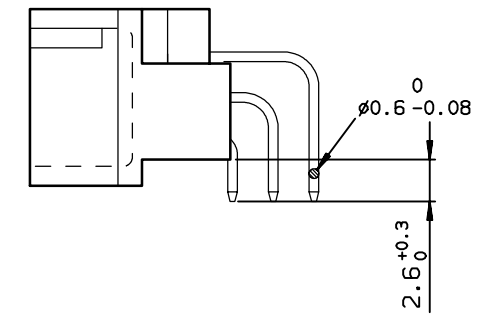

TIN LEAD PART NUMBER

PART NUMBER  
86093967113785000E1

LEAD FREE PART NUMBER

PART NUMBER  
86093967113785E1LF

PCB DRILLING

component side

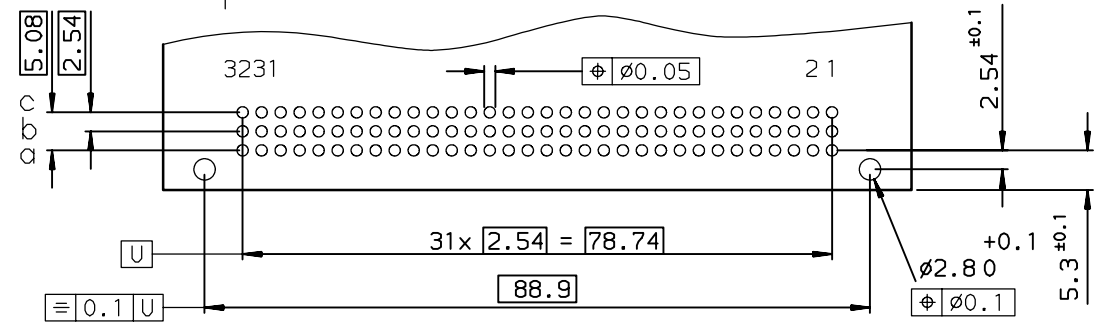

GENERAL CHARACTERISTICS AND ROHS INFORMATIONS:  
SEE DRAWING C-8609-0000A

European Views

www.fciconnect.com		surface ISO 1302 ✓	tolerance std ISO 406 ISO 1101	projection mm
TOLERANCES UNLESS OTHERWISE SPECIFIED				
Dr	ROUILLARD	1992/06/22	0.X ±0.1	size A3
Eng	TARON	1992/06/22	0.XX ±0.1	Scale 1.5
Chr	LEGARE	1992/06/22	0.XX' ±2'	ECN LS06-0095
Appr	LEGARE	1992/06/22	0.XXX ±0.1	Spec ref -
Product family DIN 8609			Standard	
		<b>STANDARD MALE 3 ROWS</b> 96 CONTACTS		Rev. C
catalog no		-		sheet 1 of 1 CUSTOMER

rev	ecn no	dr	date
A	-	-	1992/06/22
B	LS05-001	JTA	2005/03/03
C	LS06-0095	LGO	2006/06/15
-	-	-	-
-	-	-	-
-	-	-	-

Copyright FCI. FCI